

CODE	B (mm)	Fb (N)
TFP 505520	20,0	5500
TFP 505525	25,0	7000
TFP 505530	30,0	8000
TFP 505540	40,0	11000
TFP 505550	50,0	13500
TFP 505560	60,0	16500

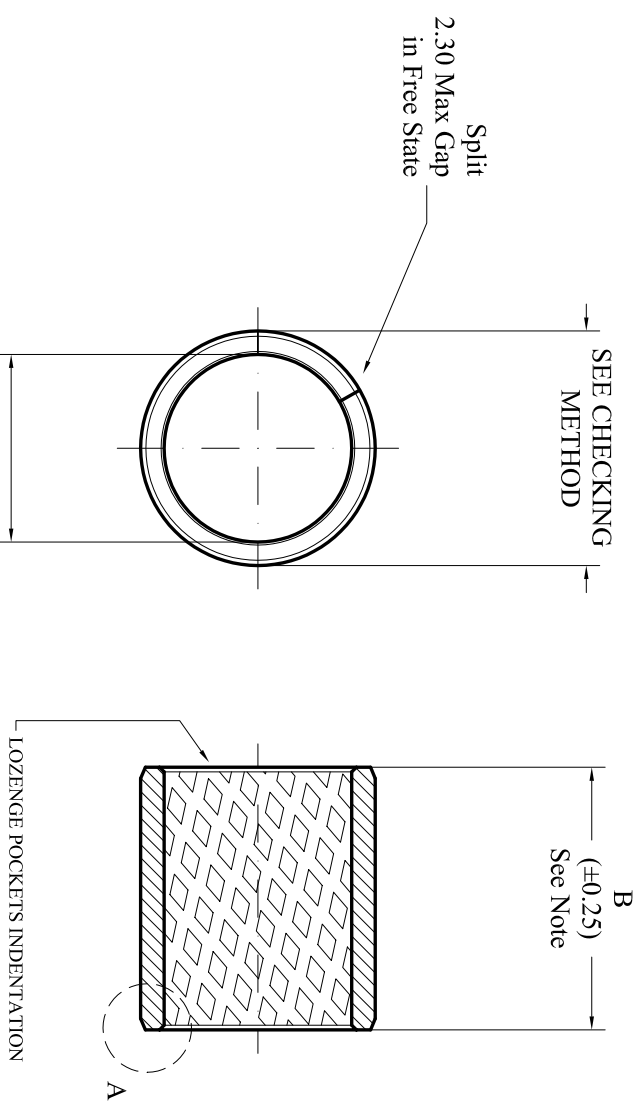

SEE CHECKING METHOD

50.000/50.062

AFTER ASSEMBLY IN HOUSING 55.00 H7

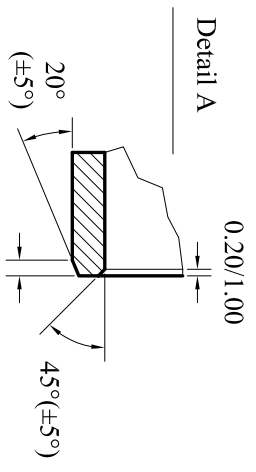

REVISION NO.:	
NO. CHANGE:	DATE DRAW
CUSTOMER APPROVAL-DATE:	
APPROVAZIONE CLIENTE-DATA:	
SIGNATURE:	
FIRMA:	

Checking "A" according to ISO 3547-2 (DIN 1494-2) Controllo "A" secondo ISO 3547-2 (DIN 1494-2)	Checking "C" according to ISO 3547-2 (DIN 1494-2) Controllo "C" secondo ISO 3547-2 (DIN 1494-2)	Q = 55,087 mm Fb = See Note Z = 0/0,070 mm
Housing/Sede 55.000	Shaft/Albero 49.950	Inside Diam. After Assbl. 50.000 / 50.062
Drawn/Disegn	Checked/Contr.	Approved/Approv.

Material/Materiale:	BRM-10
	CuSn8
Scale	Qry
Part no/Code	Date
TFP 50 55 ... BRM-10	06-06-03

	Part name/Descrizione:	Weight/Peso
	SLIDING BEARING	g
Drawing no./Disegno nr.		A4
70P0500		1-1
issue 1		

THE INFORMATION CONTAINED IN THIS DRAWING IS THE SOLE PROPERTY OF TECHNYYMON srl ANY REPRODUCTION IN PART OR WHOLE WITHOUT THE WRITTEN PERMISSION OF TECHNYYMON SRL IS PROHIBITED.